

Access ladder fall protection screen

Interesting fact here is that this fall protection was not required by the Code or any other document. I proposed it to be added (by common sense, although not required) because of real possibility if a maintenance person slip somehow, he could fall down 2 stories on concrete steps below with no chance to survive. Such an accident will be a serious problem for the client / owner of the building. Entire instruction below (3D AutoCAD model by me):

SUPPLEMENTAL INSTRUCTION No. ***

Project:	***** **	Project / File No:	*****
Contractor Name:	**** ** Construction Inc.	Date:	December 11, 2018
Contractor Address:	2000, 6900 ***** Rd #2370	Revision Date	
Attention:	Andr*** Cas*****	No. of Pages:	1 + 5

The following instruction is issued to the Contractor in accordance with Paragraph 2.2.9 of GC 2.2 – ROLE OF THE CONSULTANT in CCDC 2 – 2008. Proceeding with work in accordance with these instructions indicates the Contractor's acknowledgement that there will be no change in the Contract Price and Contract Time. If the Contractor believes that this instruction affects the Contract Price or Contract Time, the Contractor shall notify the Consultant within ten (10) days from the date of issue of this instruction.

Title: Access ladder fall protection screen

Ref. Documents:

Description:

- 376 1. Add provide fall protection screen as shown on the attached architectural sketches.
The vertical mesh screen and the attachments to be engineered.

Reason: Coordination

Requested By: Consultant

Kasian Architecture Interior Design and Planning Ltd.

Stan Zhekov – Contract Administrator

Name and Title of Person Signing



Signature

December 11, 2018

Date

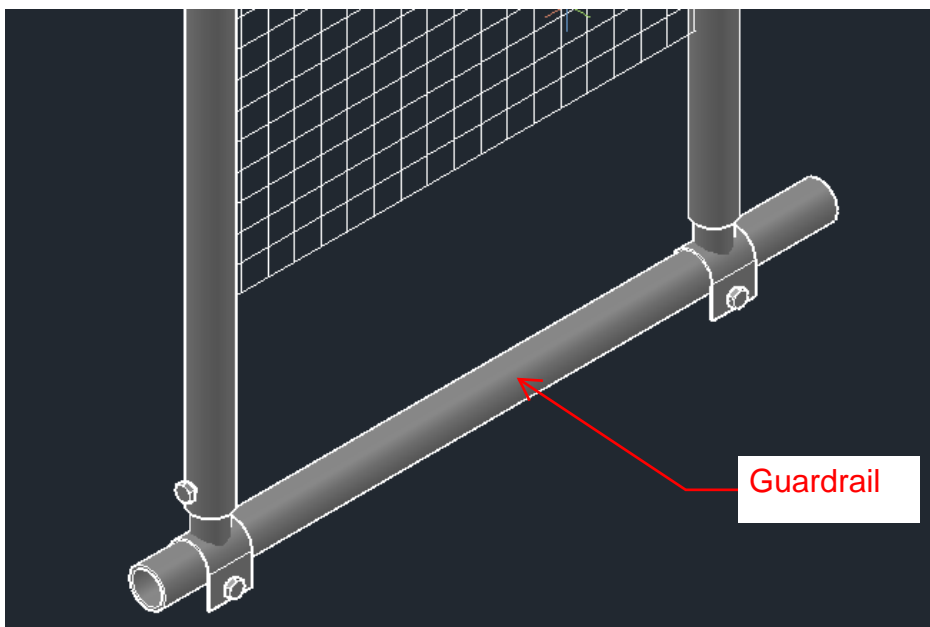
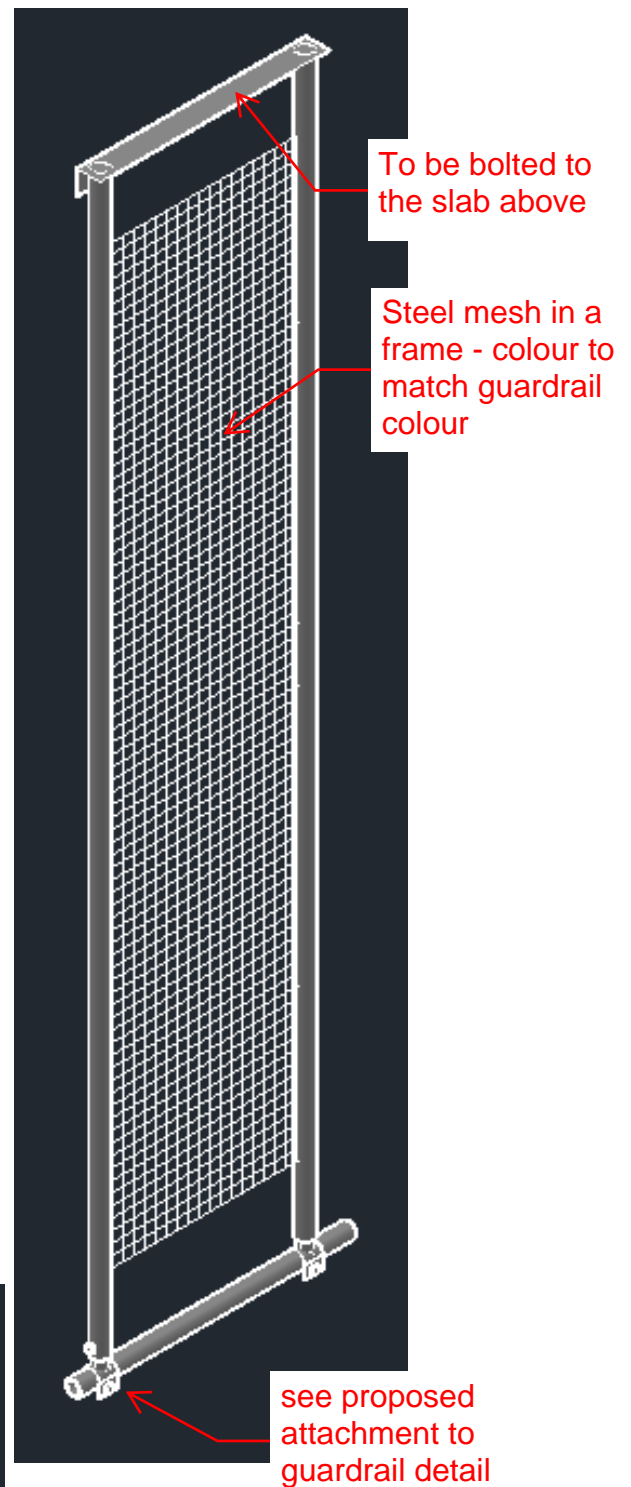
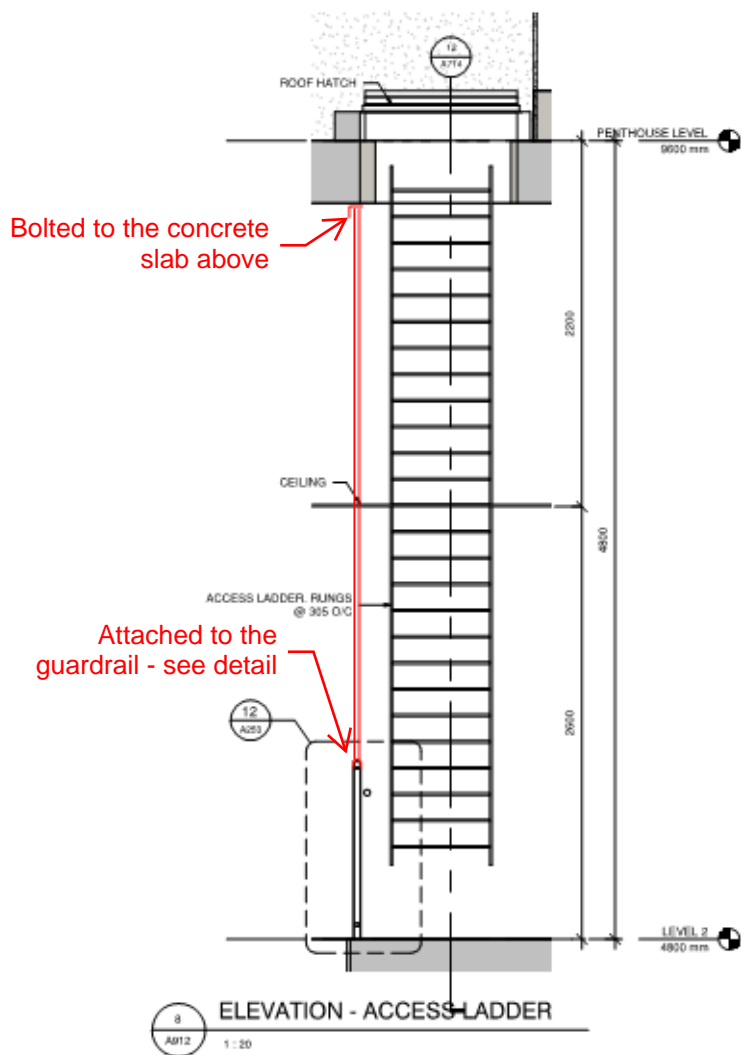

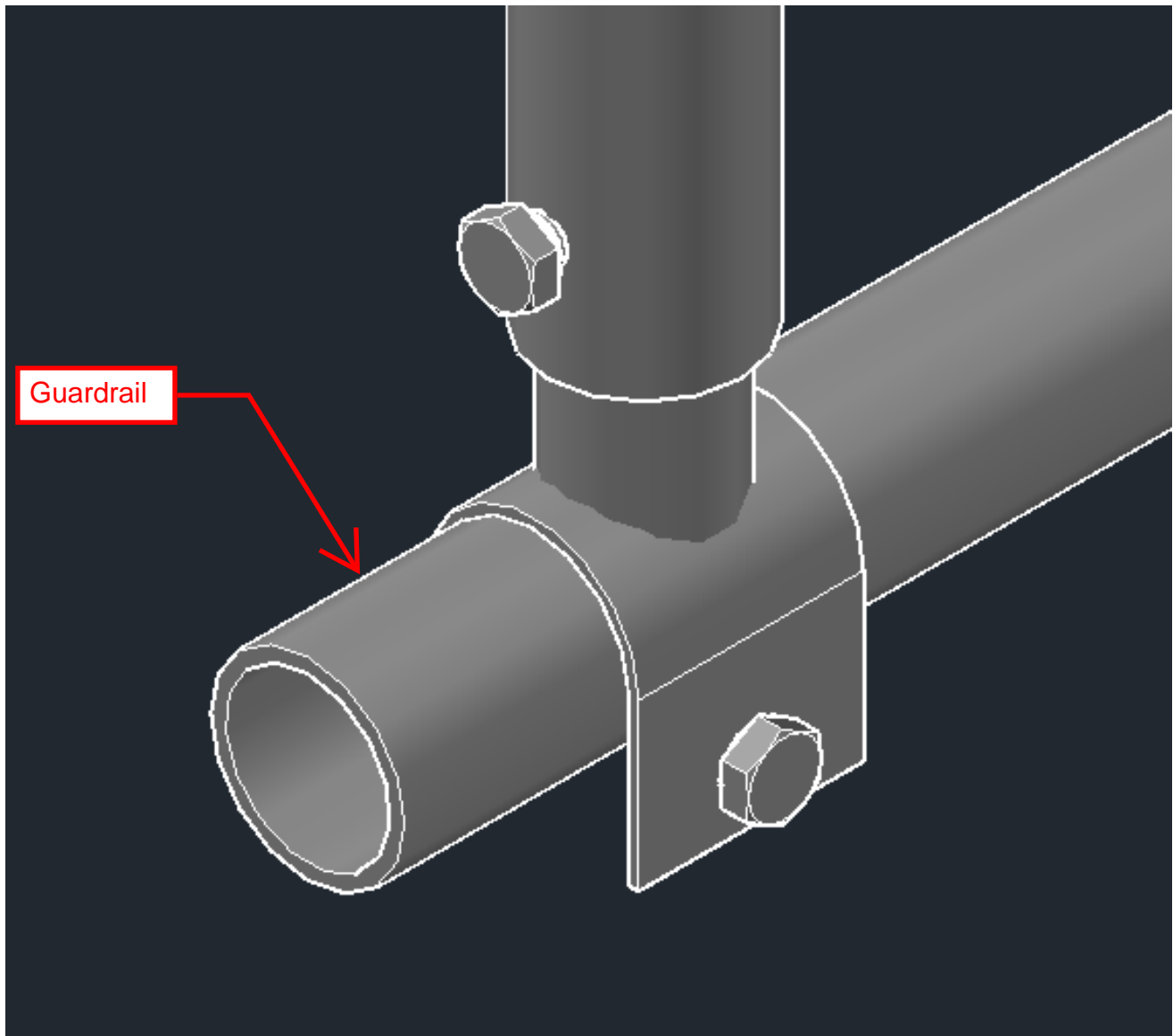

Proposed attachment to guardrail detail
NOTE: all attachment details to be engineered

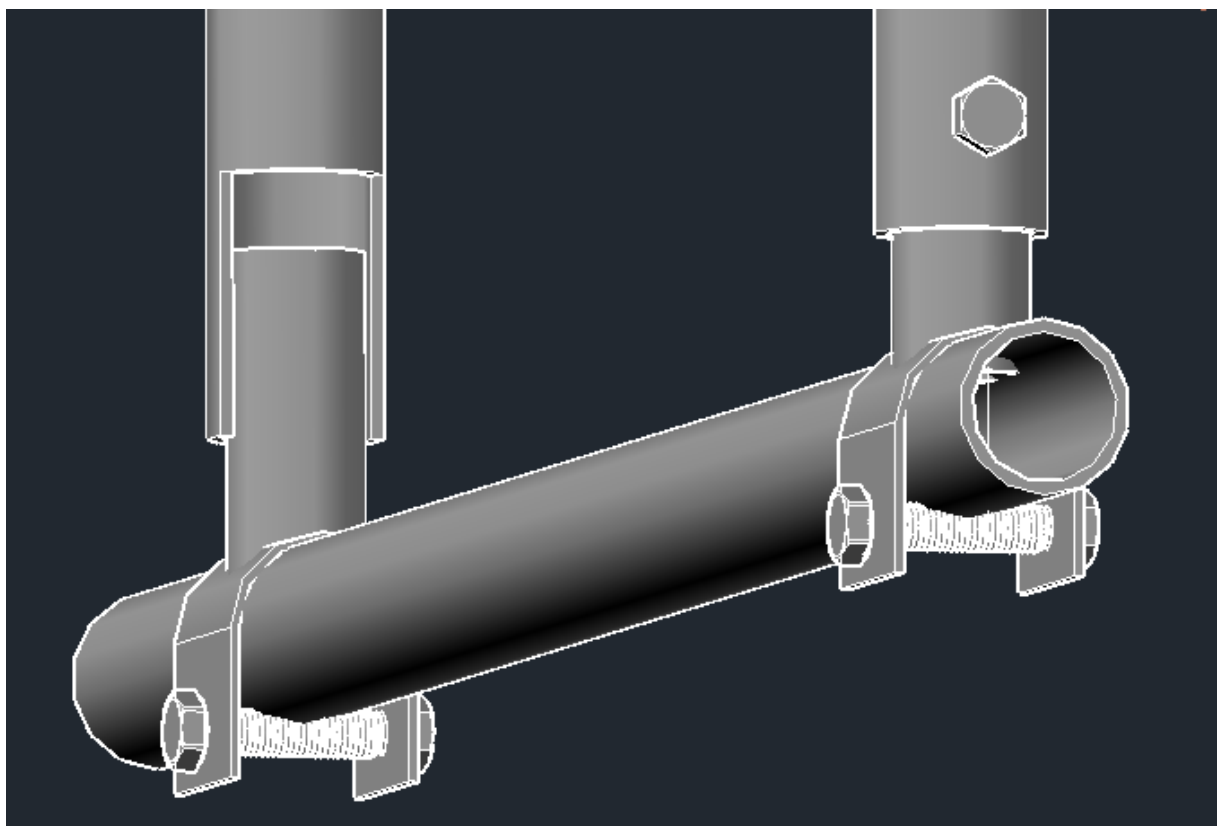
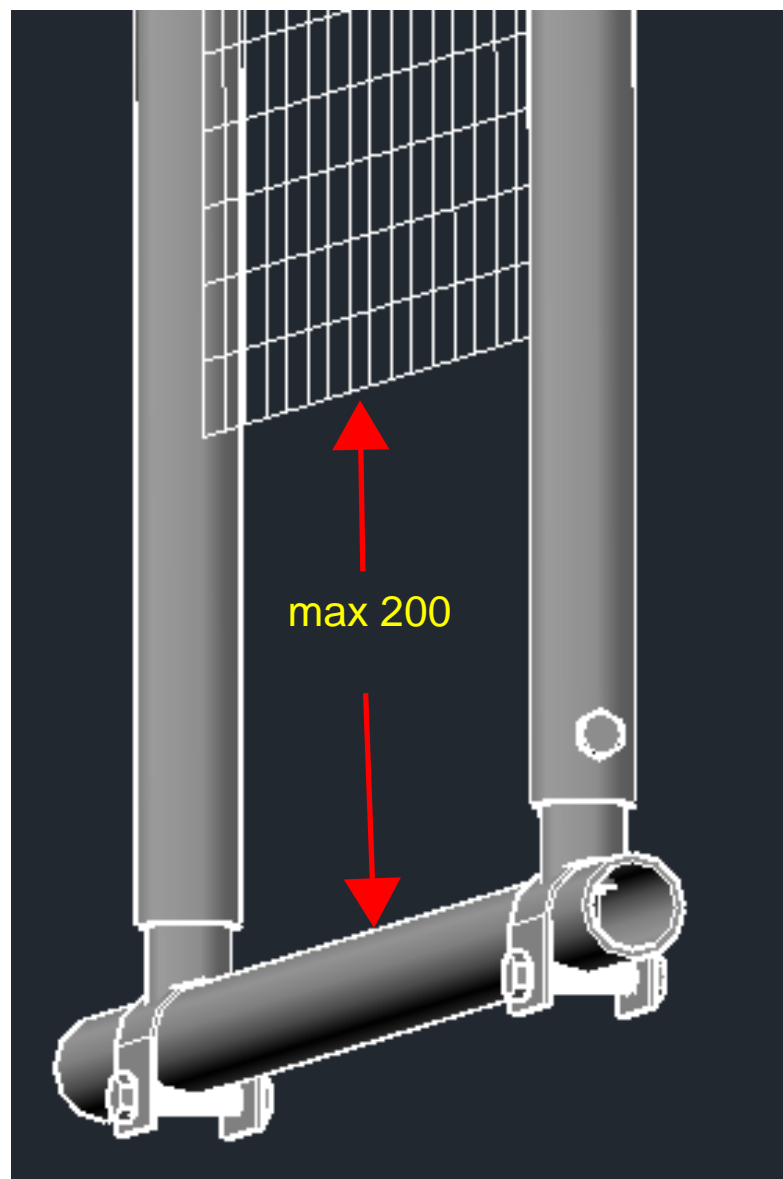

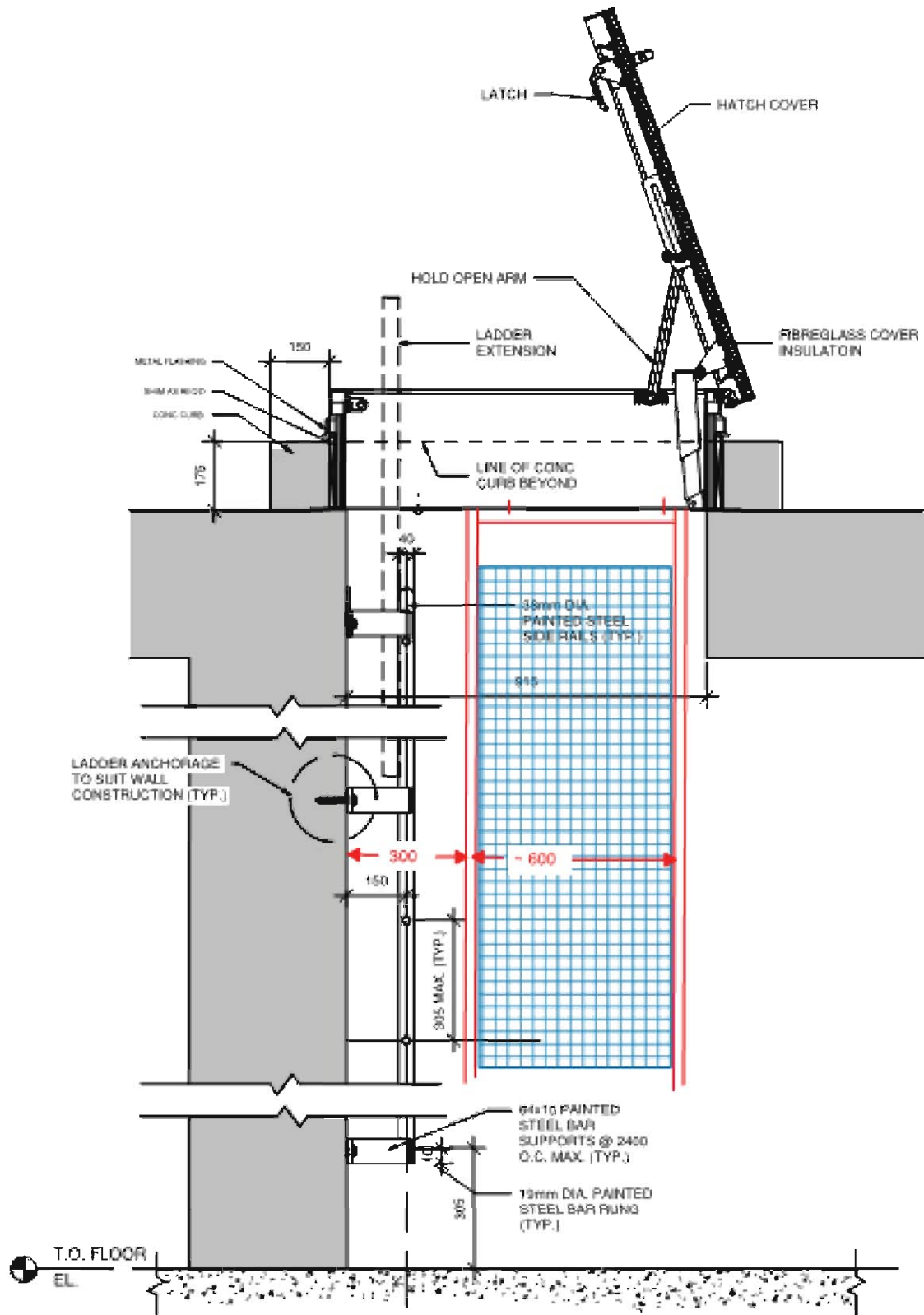



Finished / installed fall protection screen



Interior renovation for Electronic Arts offices in Burnaby – the entire 3rd floor (350 work stations)

Fixed time project – no option for extension.

The key factor in this project was constant precise synchronization and coordination with deliveries to site. For example, the truck with special custom light fixtures was stuck at the border crossing for some reason and we decided to install temporary light fixtures and replace them once the truck arrive. Of course, there were some other tweaks like discontinued carpet tiles and cabinet hardware etc. I worked closely with the contractor exploring all the options we have, assessing possible negative impact as time and cost and adjusting accordingly. I received ongoing support from the entire interior design team in our office (6 people).





Electronic Arts office renovation – Burnaby



This is an example of a clarification for non standard roof detail

Roofers on site had difficulties to figure out how exactly to waterproof this particular detail so I issued an SI

SUPPLEMENTAL INSTRUCTION No. ***

Canada Post

Project: Project / File No: *****

Vancouver Mail Processing Plant

Contractor Name: *** Design Built Construction Inc. **Date:** 8 Aug 2013

Contractor 220 -21320 Gordon way

Address: Richmond

Attention: Ju**** Mc*****

No. of Pages: 1 + 2

The following instruction is issued to the Contractor to document minor adjustments in the work which are consistent with the intent of the construction documents. Proceeding with work in accordance with these instructions indicates the Contractor's acknowledgement that there will be no change in the Contract Price and Contract Time. If the Contractor believes that this instruction affects the Contract Price or Contract Time, the Contractor shall promptly notify the design/Builder.

Title: Low canopy roof detail

Ref. Documents: Roof Field Review Report 100 item 100.7

*** 1. Refer to attached sketch for clarification regarding non standard roof detail.

Reason: Clarification

Requested By: Consultant

Kasian Architecture Interior Design and Planning Ltd.

Stan Zhekov -Contract Administrator **8 Aug 2013**

Name and Title of Person Signing Signature Date



07/31/2013 14:21

New building for DND/CAF - custom safety features

Additional double door to Mechanical room 3001 on 3rd floor with (custom) safety features as required (hand sketches by me) – the door is high above ground floor and it's needed for large equipment replacement and maintenance. This door was added because of some changes on the mechanical part during construction.

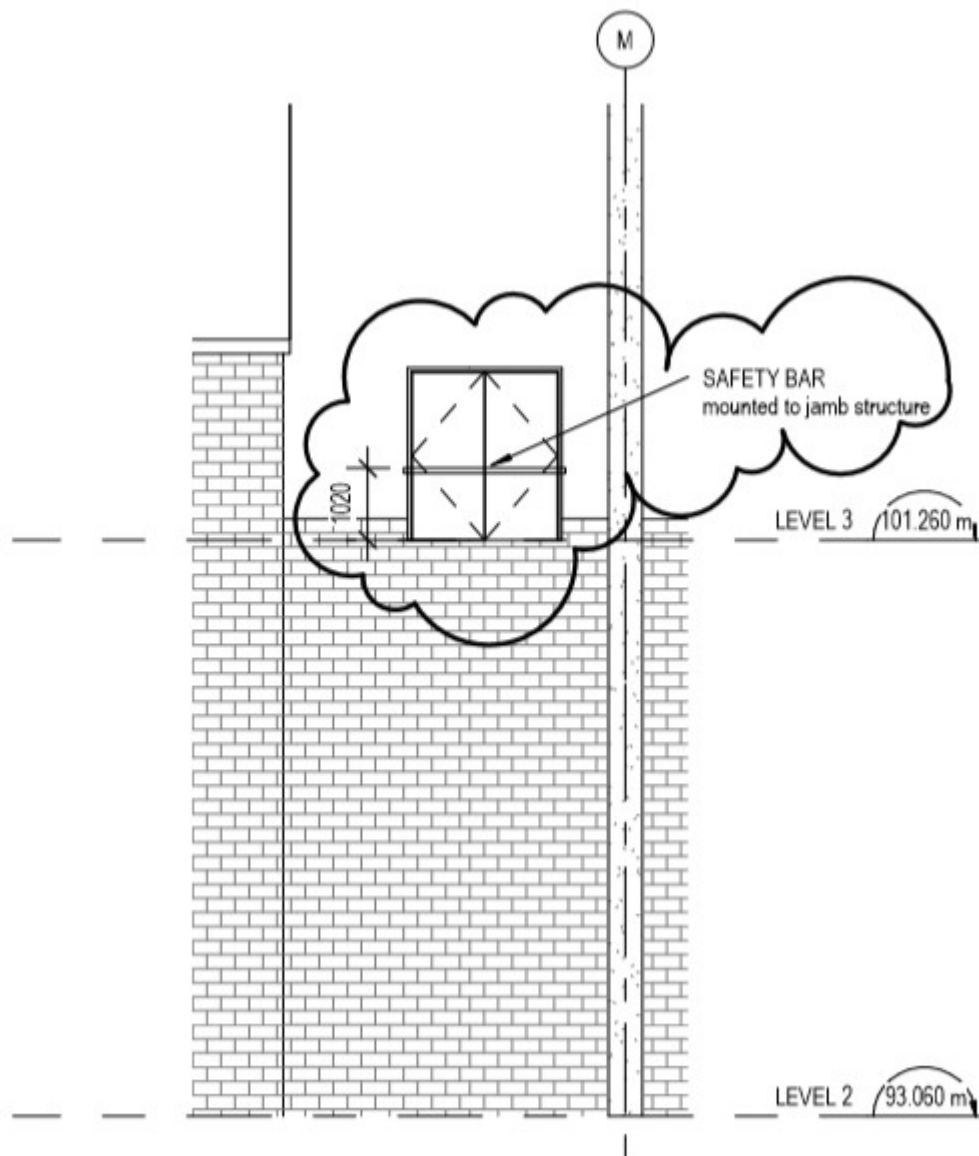

HOLLOW ALUMINUM SAFETY BAR 40x120 WITH PAINTED YELLOW STRIPES

STEEL BRACKET BOLTED THROUGH DOOR FRAME C/W STOPPER

DOOR FRAME

STEEL BRACKET PAINTED YELLOW

GALV. $\frac{1}{4}$ " CHAIN LONG ENOUGH TO PUT THE SAFETY BAR ON THE FLOOR NEXT TO THE DOOR

GALV. BOLTED EYE FOR CHAIN

DOOR

N.T.S.

ASK-113
13 June 2011

STEEL BRACKET W/ SIDE STOPPER

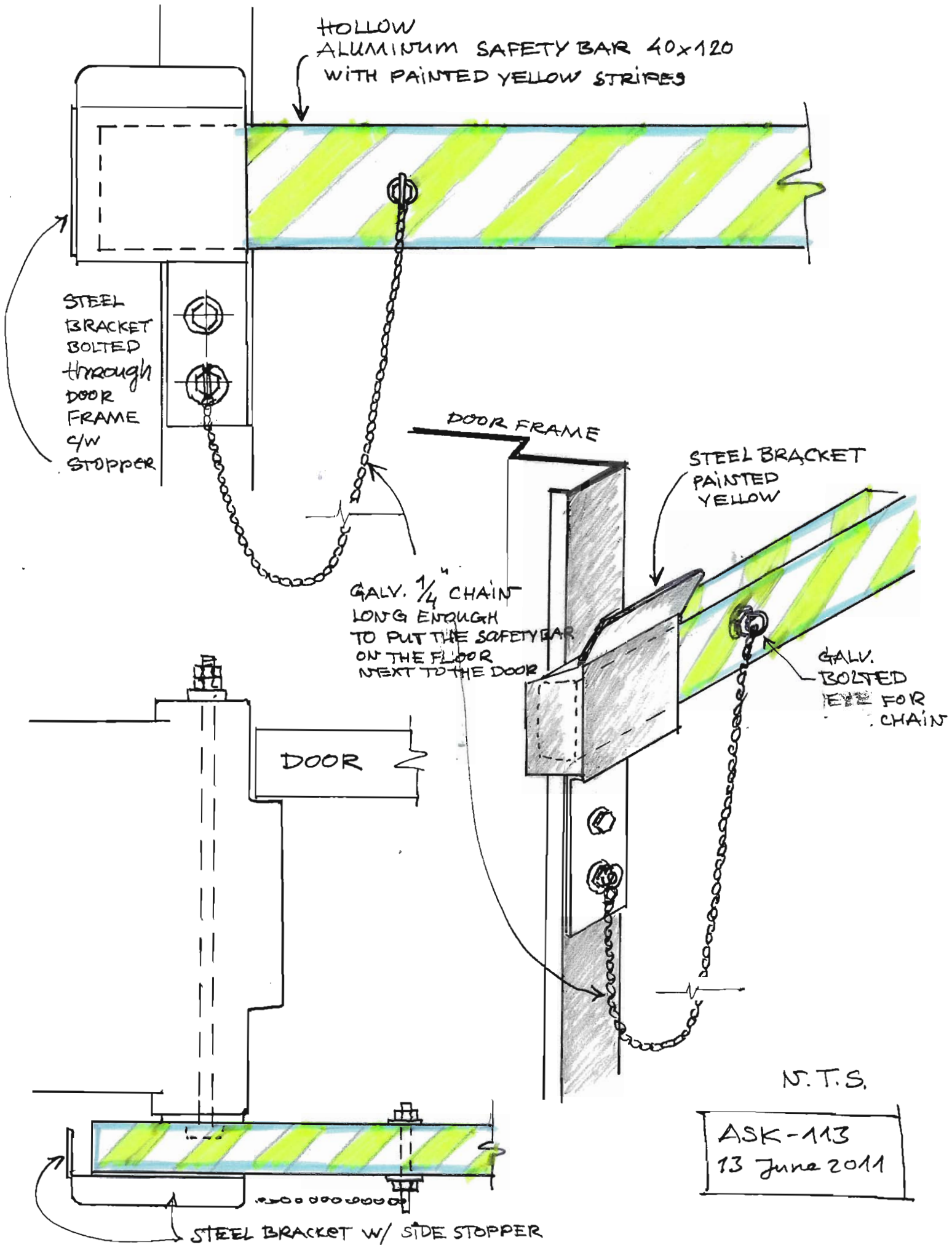

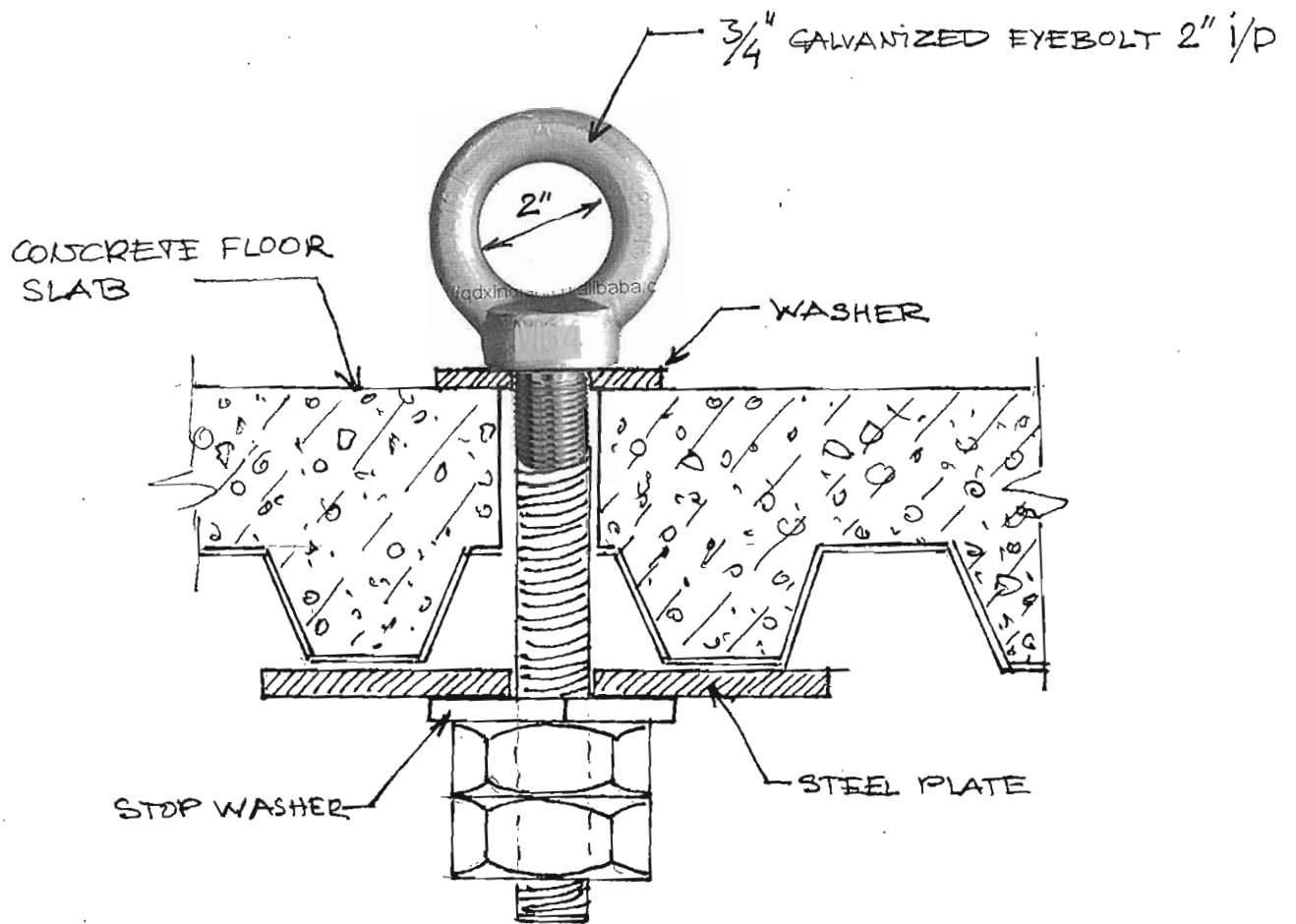

SAFETY TIE OFF
TYPICAL DETAIL

N.T.S.

ASK-115
21 June 2011